

# PROPOSED GROUND FLOOR PLAN

scale 1:100 (A3)

- FE Final Exit Notice: to comply with BS 5499
- EOD Fire exit keep clear notice: required at all fire exits
- N1 General fire notice: required at all break glass points
- N5 Fire exit keep clear notice: required at all fire exits
- N7 Push bar to open notice: required to be fitted to all doors with panic bolts
- BG Fire Blanket
- C Carbon Dioxide Fire extinguisher: as part of BS EN5 & BS 53 06 PT 1
- HD Self contained heat detector linked to fire alarm system
- SD New interlinked smoke alarms
- EM Emergency lighting for this building to be in accordance with BS5266 : part 1 : 2005, Part E
- EL External Wall light
- EL Emergency lighting for this building to be in accordance with BS5266 : part 1 : 2005, Part E
- Fire Alarm Sounder

**NOTE :** Existing fire safety to Part E installation as approved to remain unaltered where amendments are made these are indicated in red symbols

- [Grid Pattern] Allow for removing existing tiles making good sub base to receive 16mm cement tile on 4mm bed and sealed as manufacturers specification
- [Herringbone Pattern] Allow for removing existing tiles making good sub base to receive 22mm fumed oak flooring in herringbone pattern 600 x 100
- [Diagonal Lines] Existing tile floor retained and protected
- [Hatched Area] Finish to new raised floor to be fumed oak boarding 22mm thick T&G laid on 18 WPB plywood with 3 layers moisture curing resin gloss finish

Note the structural works to be signed off by the Structural Engineer and a Certificate of Validation or equal should be issued to ensure that the works have been carried out to their satisfaction at the completion of the project. The Certificate should be forwarded to Building Control upon completion of the project.

Revision D (01/12/16) Staircase amended  
 Revision E (23/12/16) Building Control comments added  
 Revision FF (28/03/17) Amendments following site visit 28/03/17

Scale 1/100 @ A3

**markmasondesign**

Project CAFE VAUDEVILLE  
 25-39 ARTHUR STREET, BELFAST

Drawing GROUND FLOOR PLANS  
 AS PROPOSED

Drawing No 196H  
 Date  
 Scale 1/100@A3  
 Drawn  
 Mark@markmasondesign.com tel 07836 775755

**DOOR SCHEDULE**

Doors marked E are existing and approved 30 mins fire resistant doors with closefits smoke seals and intumescent strips

Note New timbers in new raised area to be tanalised to BS 7671

**FINISHES**  
 All general walls, ceilings in rooms to be class 1 spread of flame.  
 All escape stairs, sterile areas to be finished with Class 0 surface of flame

Revision G (08/04/17) Food hoist door position amended  
 Revision H (04/04/17) Food hoist position amended Booth seat omitted

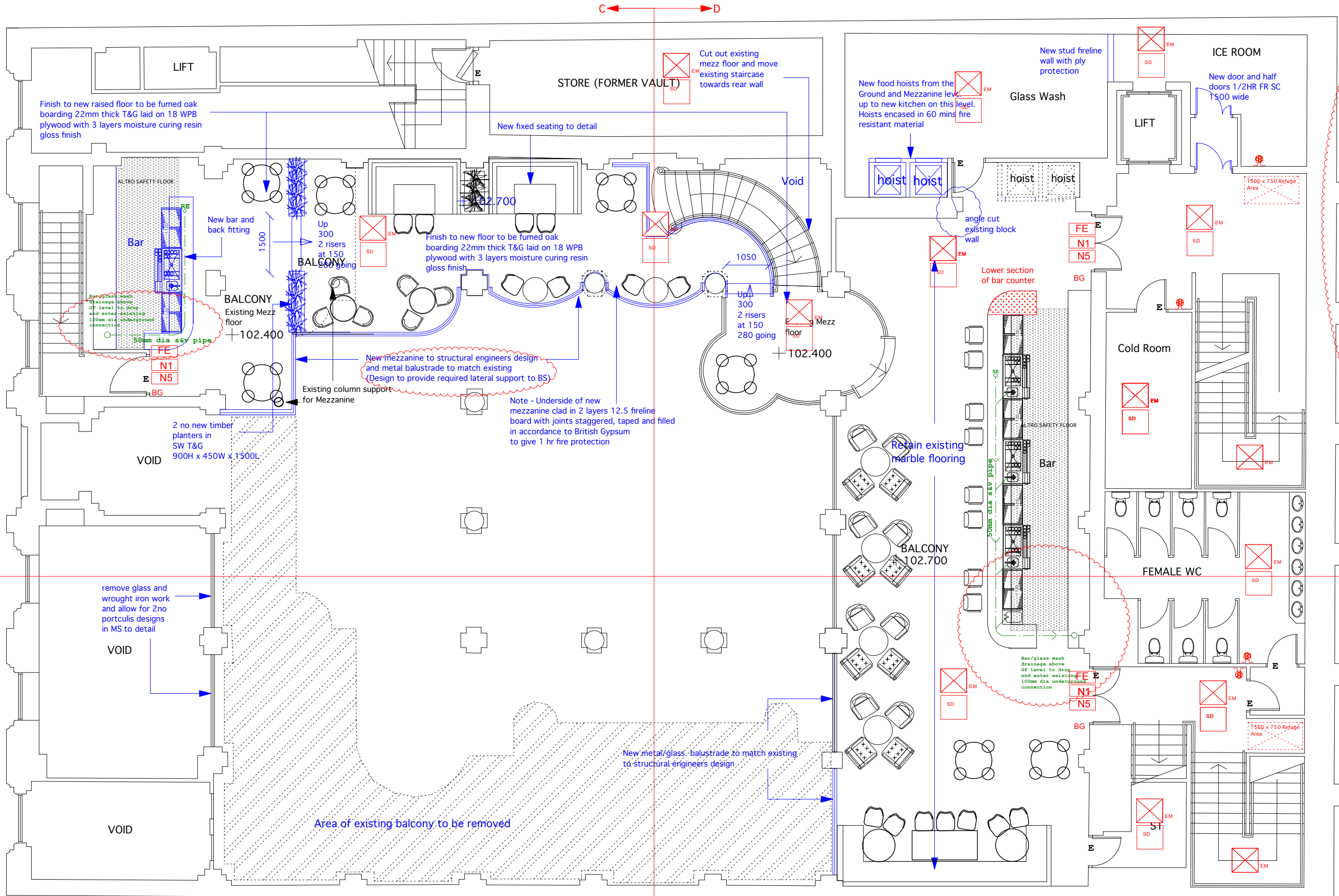

**DOOR SCHEDULE**

Doors marked E are existing and approved 30 mins fire resistant doors with closers smoke seals and intumescent strips

Note  
New timbers in new raised area to be tanalised to BS 7671

**FINISHES**  
All general walls, ceilings in rooms to be class 1 spread of flame.  
All escape stairs, sterile areas to be finished with Class 0 surface of flame

**PROPOSED MEZZANINE LEVEL PLAN**  
scale 1:100 (A3)

- FE Final Exit Notice: to comply with BS 5499
- EOD Easy Opening Device: To comply with relevant BS
- N1 General fire notice: required at all break glass points
- NS Fire exit keep clear notice: required at all fire exits
- NF Push bar to open notice: required to be fitted to all doors with panic bolts

**NOTE :** Existing fire safety to Part E installation as approved to remain unaltered where amendments are made these are indicated in red symbols

Note the structural works to be signed off by the Structural Engineer and a Certificate of Validation or equal should be issued to ensure that the works have been carried out to their satisfaction at the completion of the project. The Certificate should be forwarded to Building Control upon completion of the project.

- Fire Blanket
- W Water Fire extinguisher: as part of BS EN5 & BS 53 06 PT 1
- C Carbon Dioxide Fire extinguisher: as part of BS EN5 & BS 53 06 PT 1
- HD Self contained heat detector linked to fire alarm system
- SD New interlinked smoke alarms
- EM Emergency lighting for this building to be in accordance with BS5266 : part 1 : 2005. Part E
- EL External Wall light
- BG Break glass point to comply with BS5266 Pt1:1999 requirements
- SS Smoke seal: Intrinscment strips smoke seal routed into door frame
- SC Self closer fitted to door leaf

HOD Hold Open Device: Electronically Operated hold open device fitted to leaf linked directly to fire alarm system. Device to comply with BS 7273-4: 2007



Revision H (04/04/17)  
Food hoist position amended

Revision E (23/12/16)  
Building Control comments added

Revision F (28/03/17)  
Layouts amended as site visit 28/03/17

Scale 1/100 @ A3

**markmasondesign**

Project CAFE VAUDEVILLE  
25-39 ARTHUR STREET, BELFAST

Drawing FIRST FLOOR PLANS  
AS PROPOSED

Drawing No 197H  
Date 197H

Scale 1/100@A3  
Drawn

Mark@markmasondesign.com tel 07836 775755